

CATALOG#	DESCRIPTION	COLOR
FOR3U12SPNA	FIBER, RKMNT, PNL, 3U, 12 FSP, PNL, UNLD, NA	BLACK

DESCRIPTION	QTY.
PLASTIC FIBER SPOOL	4
10.75" BLACK WIRE TIE	8
10-32 NYLON WING NUT	1
12-24X3/8 PHILLIPS PH SCR	4
DANGER LABEL,FO PRODUCTS	1
VELCRO STRAP-8" BLACK	2
WASHER,FLAT,SPECIAL,NYLON	3
10-32X4" 18-8 SS STUD	1
LABEL SHT,3U & 4U MATRIX	2
FCR, NA, INSTRUCTION SHEET	1
FIBER ROUTING SPOOL, 30mm	2
FOR LABEL HOLDER	1

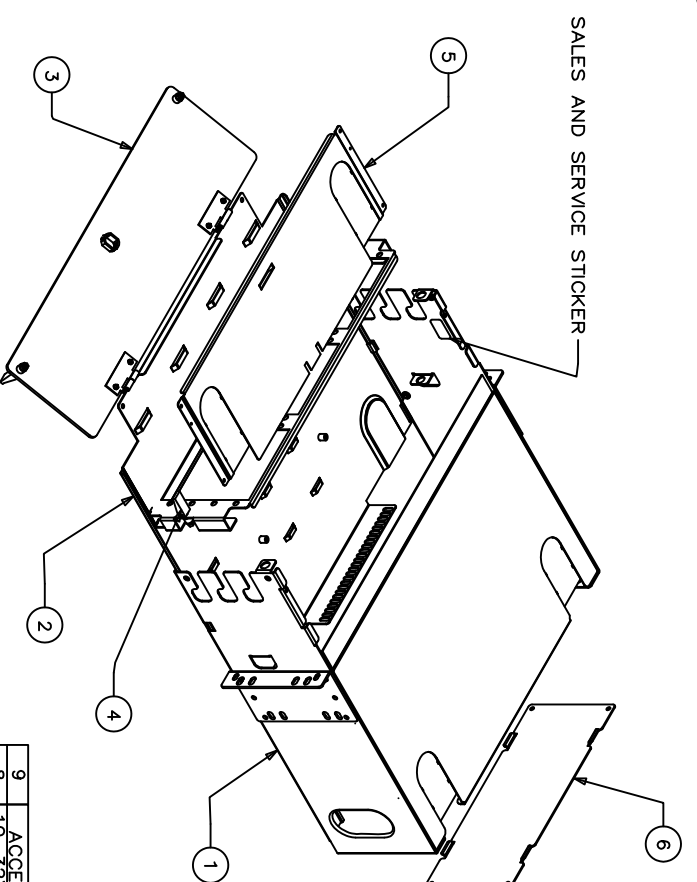
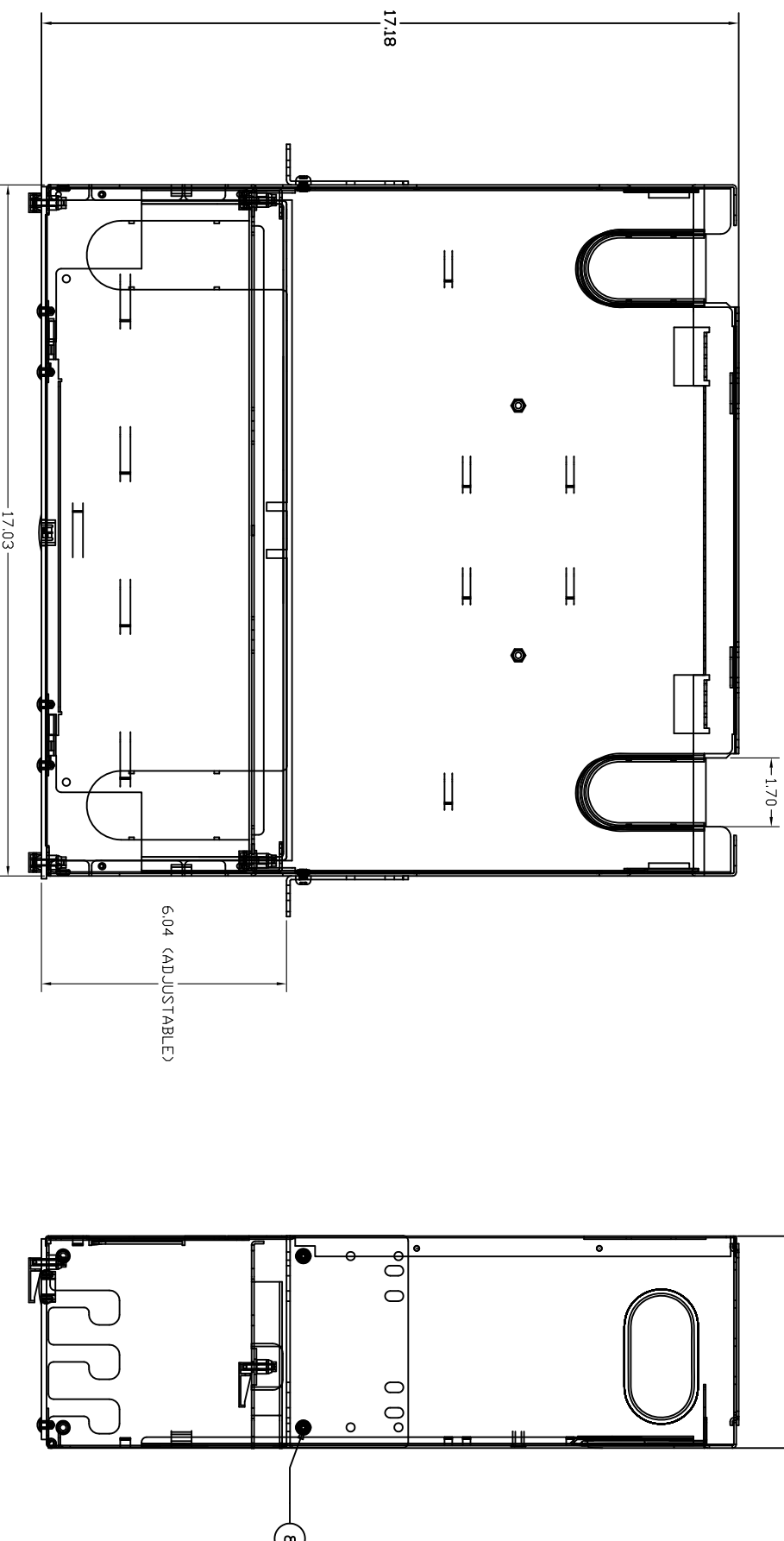

ITEM	DESCRIPTION	QTY
9	ACCESSORY KIT	1
8	10-32X1/4" SCRWS	4
7	MOUNT BRKT	2
6	REAR PANEL	1
5	COVER-TOP FRONT	1
4	SWELL LATCH	2
3	DOOR ASSY-3U	1
2	TRAY ASSEMBLY	1
1	CHASSIS	1

- NOTES:
1. REMOVEABLE/SLIDE OUT TOP FRONT COVER.
  2. REMOVEABLE REAR DOOR, FRONT DOOR, AND ADAPTER TRAY.
  3. 19" AND 23" RACK MOUNTABLE.
  4. ACCEPTS UP TO TWELVE MODULAR SIX-PACK ADAPTER PANELS.
  5. FRONT COVER LOCKING OPTION.
  6. BUILT IN CABLE/PATCH CORD MANAGEMENT FEATURES.
  7. BLACK ELECTROSTATICALLY APPLIED POWDER COAT.
  8. CABINET OCCUPIES 3 RACK SPACES.
  9. SPECIFICATIONS SUBJECT TO CHANGE WITHOUT NOTICE.

REV.	ECN	DATE	DESCRIPTION	CHG BY	APPD BY
1	18059	12/12/12	INITIAL RELEASE	DPO	

Created on AUTOCAD

DIMENSIONING AND TOLERANCE PER ANSI Y14.5M-1992 UNLESS OTHERWISE SPECIFIED, DIMENSIONS ARE IN INCHES (MM). TOLERANCES: .XX" = ±.01 (25) .XXX" = ±.005 (127) .XXXX" = ±.002 (50) ANGLE TOL. .1°

IN ACCEPTING OUR DRAWINGS, BLUEPRINTS, OR SUPPORTING DOCUMENTATION FOR QUOTATION OR OTHER PURPOSES, YOU AGREE TO DISCLOSE TO OTHERS THE DESIGN AND OTHER INFORMATION SHOWN HEREIN, AND THAT YOU WILL MAKE NO USE OF SAME WITHOUT PERMISSION.

PROJECT REFERENCE: 2011-014

MATERIAL: 23 CLARA DRIVE, SUITE 103 MASTIC, CT 06355

DRAWN BY: D.O'CONNOR 12/12/12

CHECKED BY:

APPROVED BY:

TITLE: 3U FIBER OPTIC ENCLOSURE FOR 6 PACK, NA

Hubbell Premise Wiring  
HUBBELL INCORPORATED (Delaware)  
23 CLARA DRIVE, SUITE 103 MASTIC, CT 06355

SIZE: DRAWING NO. HWS12934C

SCALE: 1/1

SHEET 1 OF 1

REV. 1